



SHOULDICE
STONE

TECHNICAL DETAILS

Apex Stone - Smooth

PRODUCT DRAWINGS

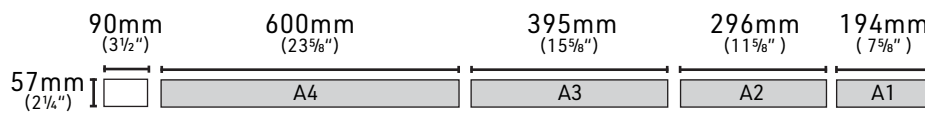
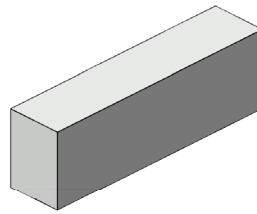

		Piece Ratios			
Unit		A4	A3	A2	A1
Quantity		2	1	2	1
					Total: 6

PRODUCT DETAILS

	Metric	Imperial
Selling UoM		SF
Units/Skid	8.73m ²	94sf
Weight/UoM	13.05kg	28.79lbs
Weight/Piece	N/A	N/A
Weight/Skid	1,245.56kg	2,746lbs
Pieces/Skid	N/A	N/A
# of Layers	10	10
Pieces/Layer	N/A	N/A
UoM/Layer	0.87m ²	9.4sf
Pieces/UoM	N/A	N/A
Pallet Size	101cmx122cm	40"x48"

CORNERS

Corners are included
100% of the units are corners

TYPICAL INSTALLATION PATTERN

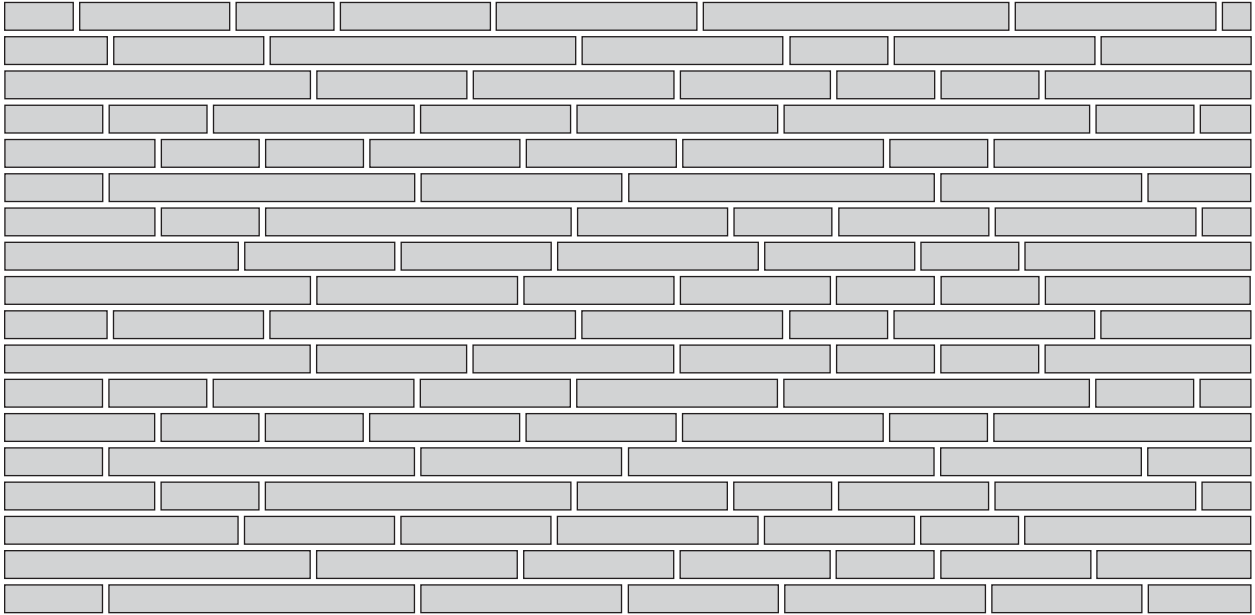

Typical Installation Guidelines: • Blend product from multiple packages for most natural look

TYPICAL MORTAR JOINT

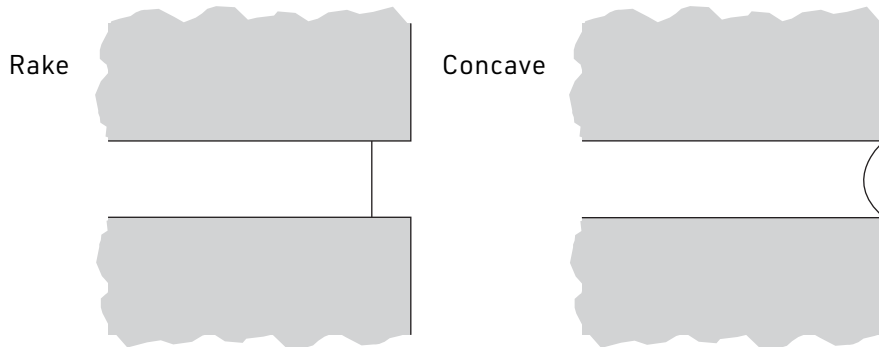

Recommended Mortar Joint 10mm ($\frac{3}{8}$ ")

TYPICAL COURSING GUIDE

Table includes one unit and one joint.

Vertical Units	10mm Joint	$\frac{3}{8}$ " Joint
1	67mm	2 $\frac{5}{8}$ "
2	134mm	5 $\frac{1}{4}$ "
3	201mm	7 $\frac{7}{8}$ "
4	268mm	10 $\frac{1}{2}$ "
5	335mm	13 $\frac{1}{8}$ "
6	402mm	15 $\frac{3}{4}$ "
7	469mm	18 $\frac{3}{8}$ "
8	536mm	21"
9	603mm	23 $\frac{5}{8}$ "
10	670mm	26 $\frac{1}{4}$ "
20	1,340mm	52 $\frac{1}{2}$ "
30	2,010mm	78 $\frac{3}{4}$ "
40	2,680mm	105"
50	3,350mm	131 $\frac{1}{4}$ "
100	6,700mm	262 $\frac{1}{2}$ "

CODES & STANDARDS

Shouldice Stone Products are supported by the following National Codes & Standards. Refer to local building codes and standards to confirm best practice.

CANADIAN

CSA A165 Standards on Concrete Masonry Units
 CSA A371 Masonry Construction for Buildings
 CSA A179 Mortar and Grout for Unit Masonry
 CSA A370 Connectors for Masonry

AMERICAN

ASTM C55 Specification for Concrete Building Brick
 ASTM C90 Specification for Loadbearing Concrete Masonry Units
 ASTM C270 Specification for Mortar for Unit Masonry
 ASTM C476 Specification for Grout for Masonry
 ASTM C1634 Specification for Concrete Facing Brick and Other Concrete Masonry Facing Units

NCMA TEK 8-4A Cleaning Concrete Masonry
 NCMA TEK 9-1A Mortars for Concrete Masonry
 NCMA TEK 8-3A Control and Removal of Efflorescence
 NCMA TEK 10-4 Crack Control for Concrete Brick and other Concrete Masonry Veneers
 NCMA TEK 19-5A Flashing Details for Concrete Masonry Walls